

# Bracing Instructions

(BB2 Patch hinge type).

10.23

## Parts Supplied:-

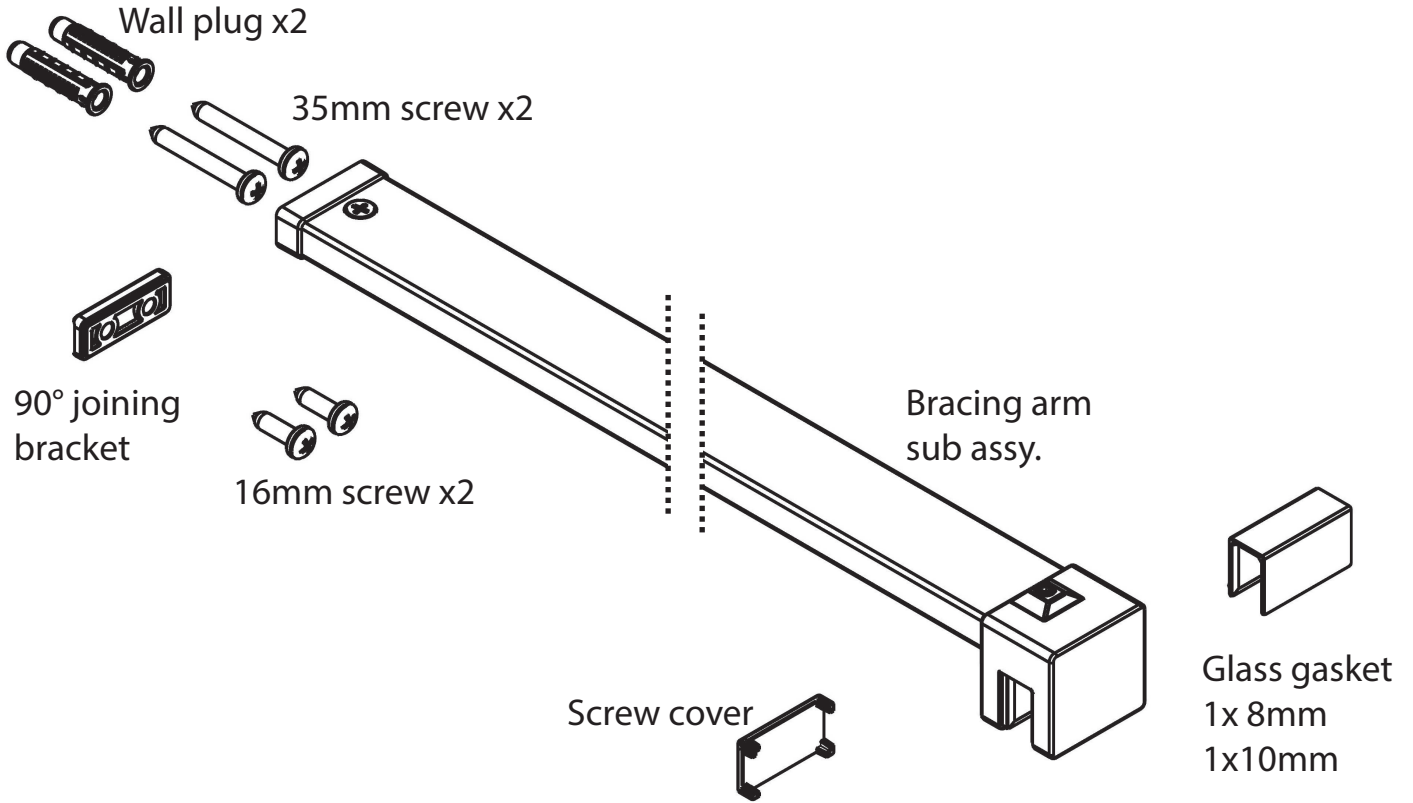

Ensure plumb. Measure from inside of main panel to back wall (X).

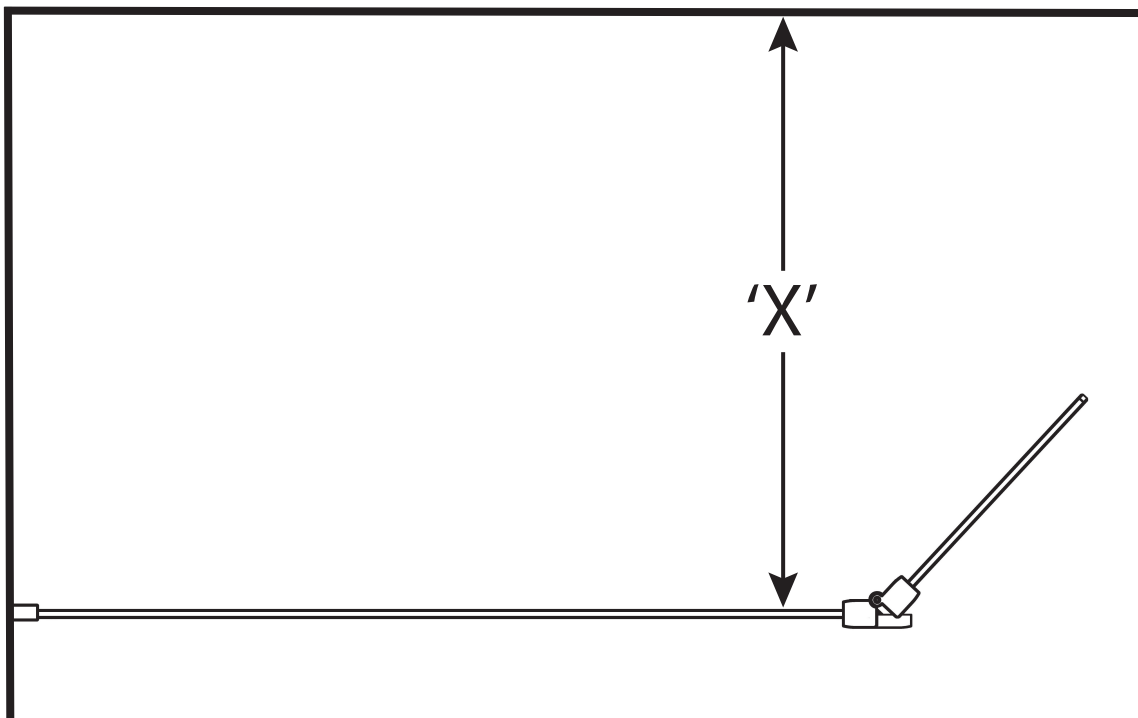

## Cut Bar:

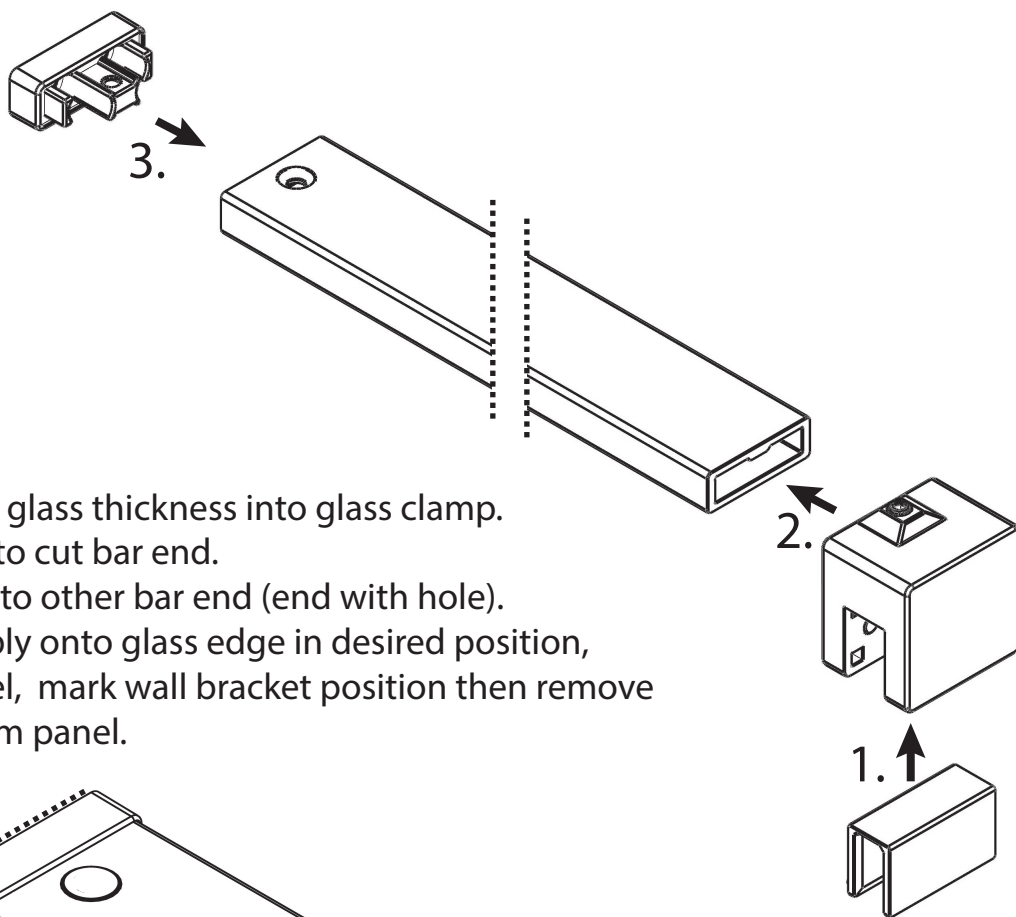
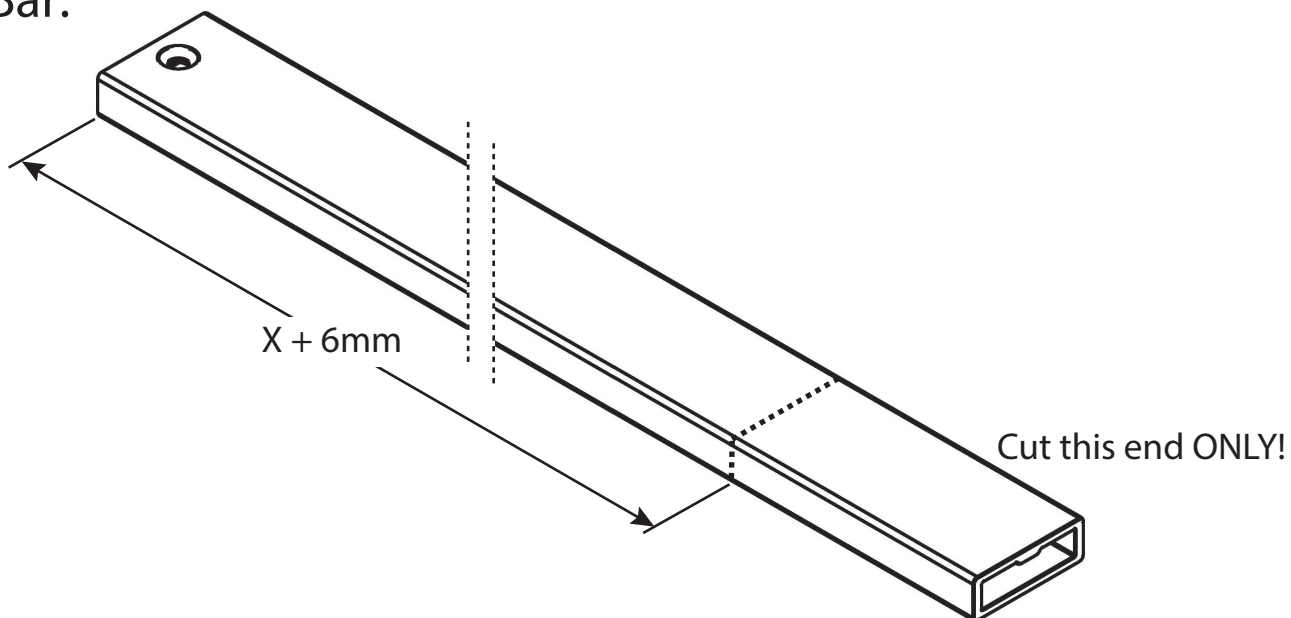

1. Fit correct gasket for glass thickness into glass clamp.
2. Place glass clamp onto cut bar end.
3. Place wall bracket onto other bar end (end with hole).
4. Offer bracing assembly onto glass edge in desired position, ensure bracing is level, mark wall bracket position then remove bracing assembly from panel.

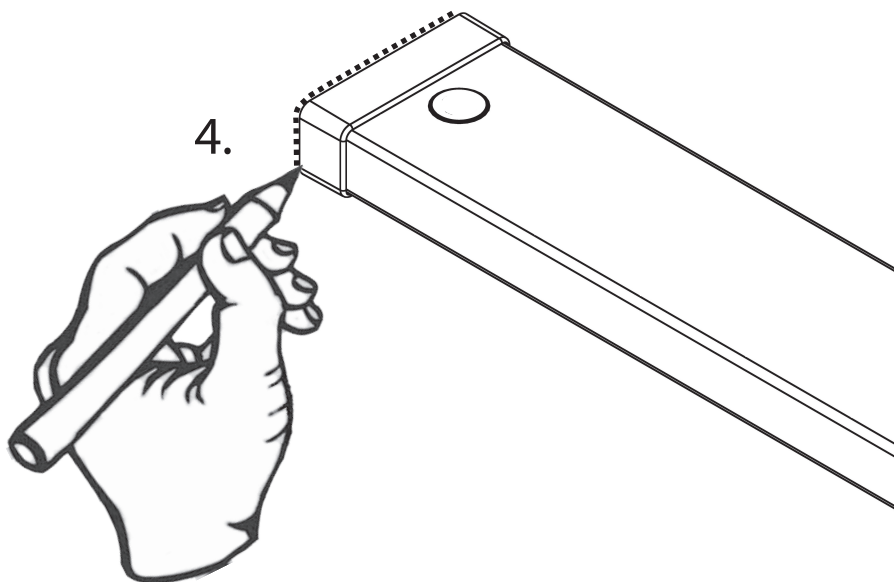

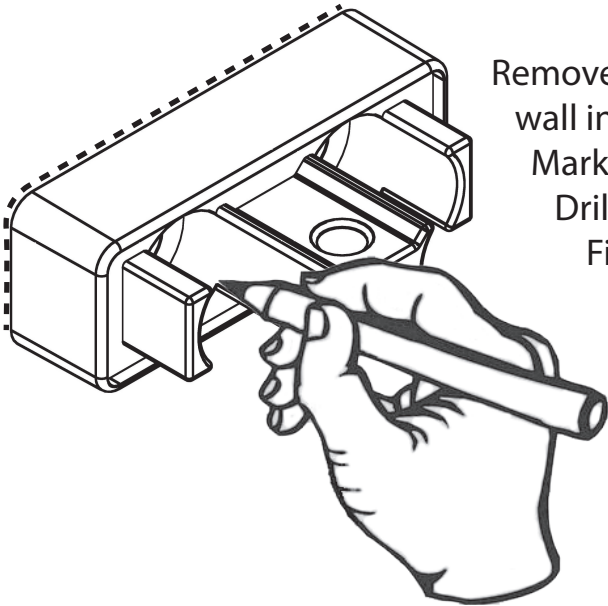

Remove wall bracket from bracing assembly and offer onto wall in marked position.

Mark through centre of 2x holes.

Drill marked positions with a 6mm tile / masonry bit.

Fit wall plugs.

Fix wall bracket using 2x 35mm screws.



Replace glass clamp onto bracing bar end.

Place wall bracket end of bracing bar onto wall bracket and glass clamp onto top of glass, fix with M3 screw.

1. Tighten 2x grub screws in back face of glass clamp.

2. Tighten grub screw on top of glass clamp.

3. Push fit screw cover.

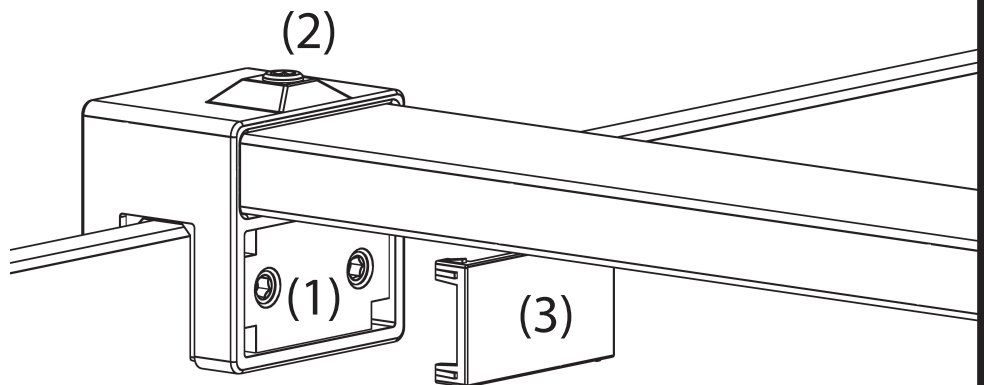

## Side Panel Bracing:-

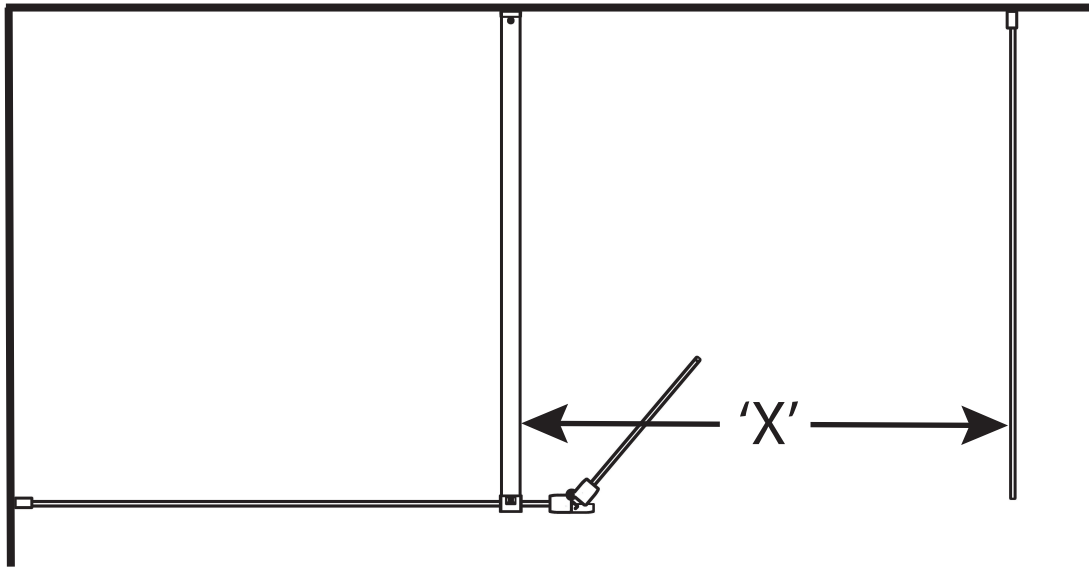

Ensure plumb. Measure from main bracing arm to inside of side panel glass (X).

## Cut Bar:

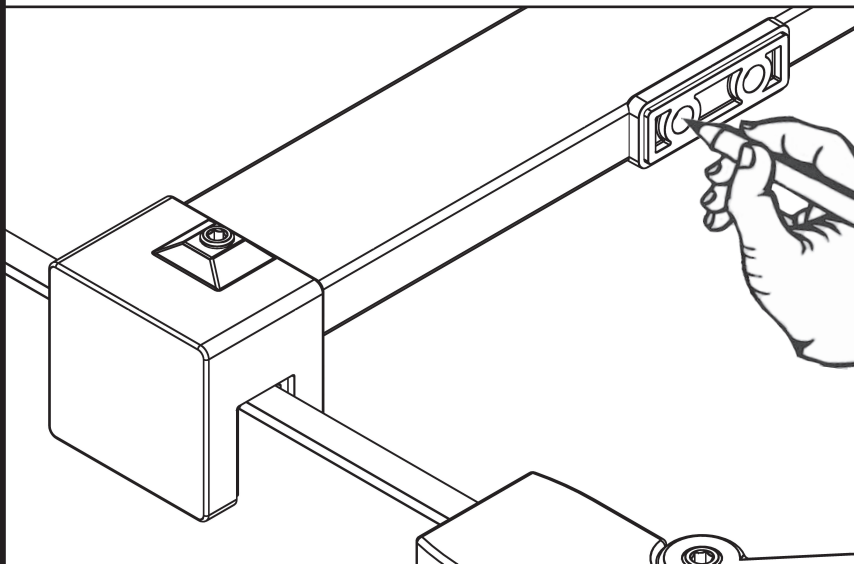
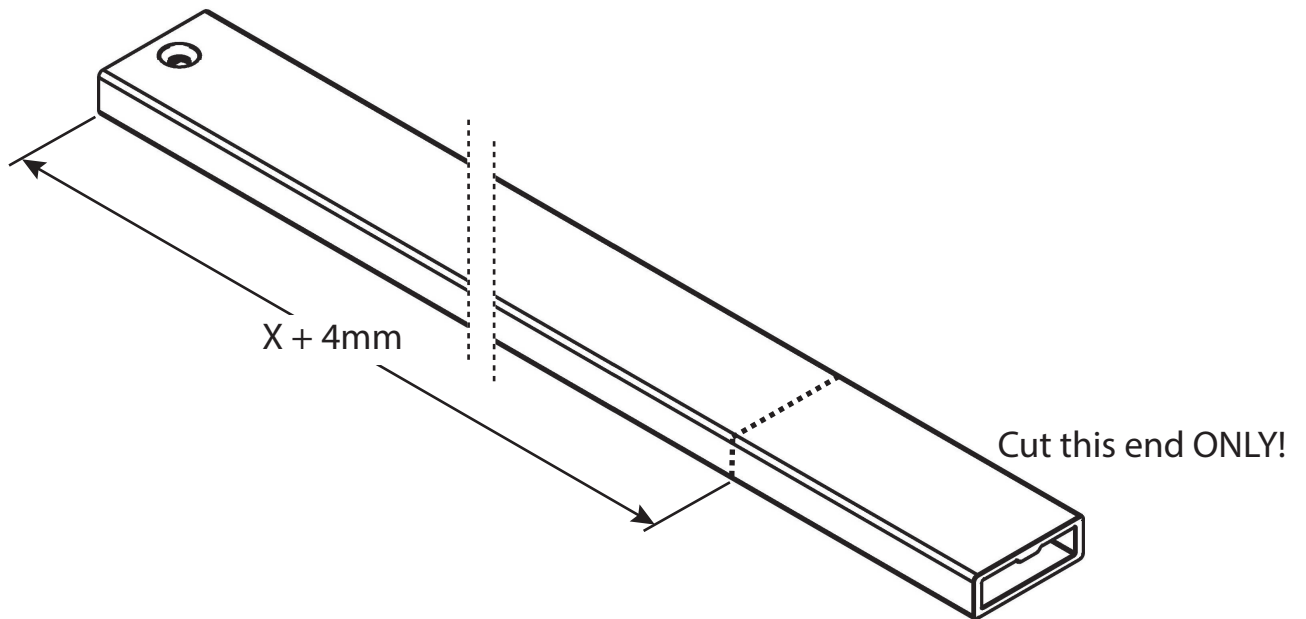

Offer 90° joining bracket onto main panel bracing arm and mark through 2x holes.  
Drill marked positions with 3mm drill bit.

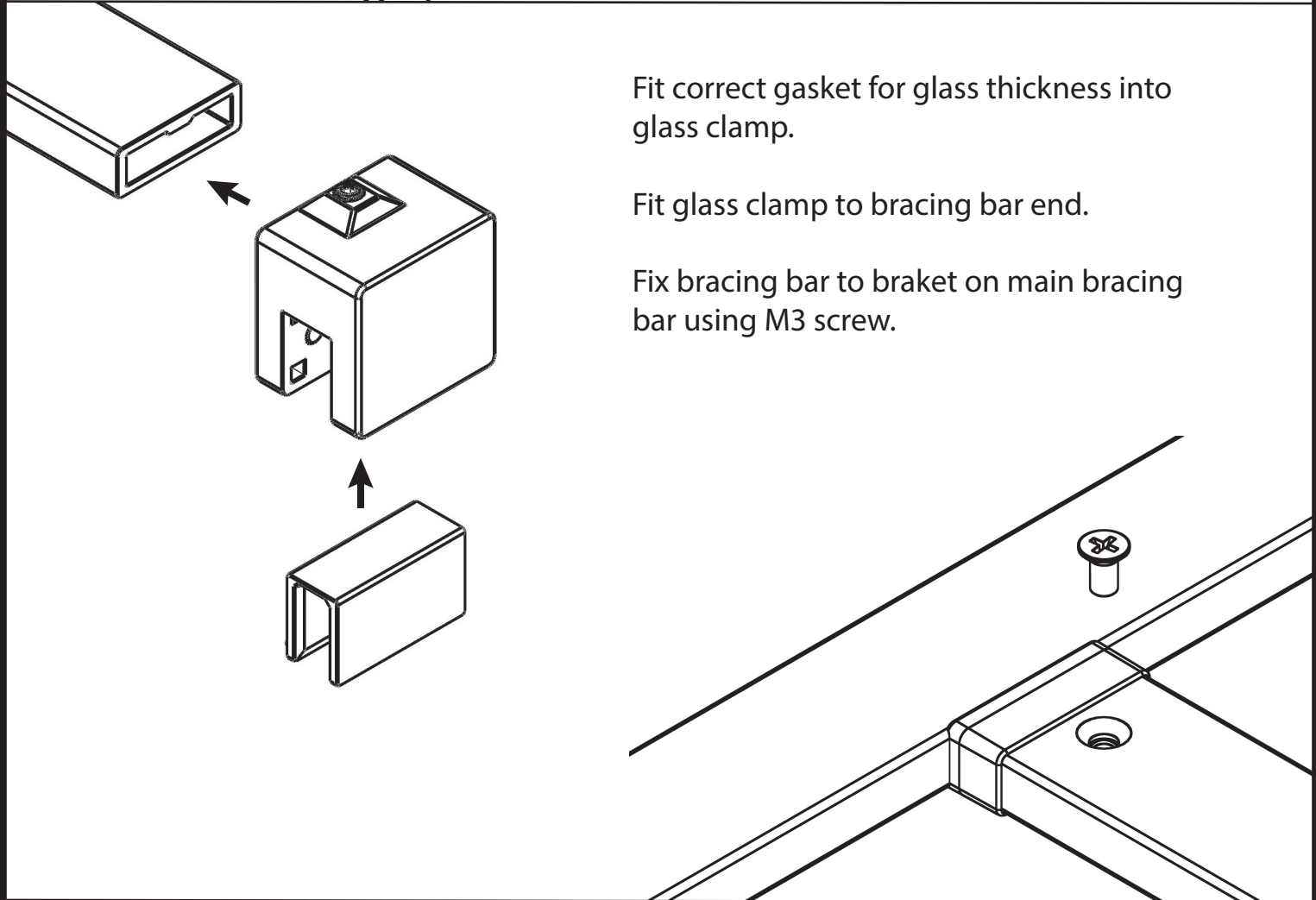
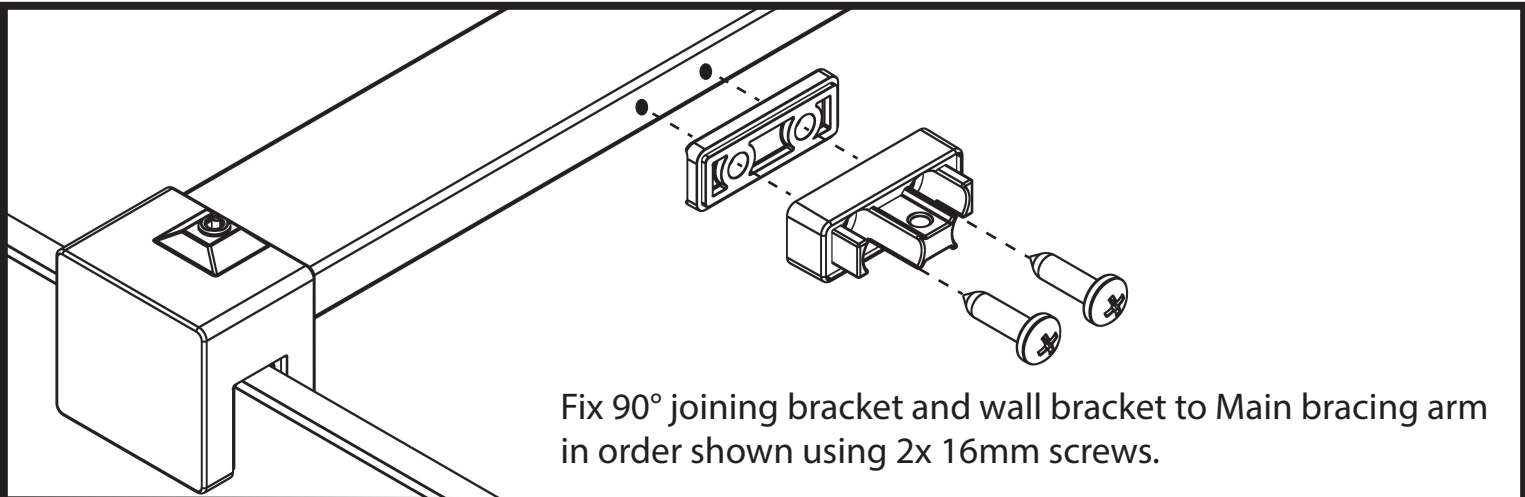

1. Tighten 2x grub screws in back face of glass clamp.

2. Tighten grub screw on top of glass clamp. (2)

3. Push fit screw cover.

